

SOUTH MELBOURNE 13 Heather Street



CAYZER

SOUTH MELBOURNE 13 Heather Street

"RUSHWORTH" - PARKSIDE FAMILY HOME

- Lock Up Garage
- Ducted heating and cooling plus terrific storage
- Central to Botanic Gardens, Albert Park Lake, South Melbourne Market with easy access to CBD

Modern built while respectfully blending into the heritage streetscape, this townhouse offers surprisingly spacious family living opposite a cheerful playground. Comprising a generous living zone filled with northern light through to a family-sized kitchen meals that spills onto a private yard. The generous bedrooms are served by two bathrooms (one with tub) and an additional powder room.

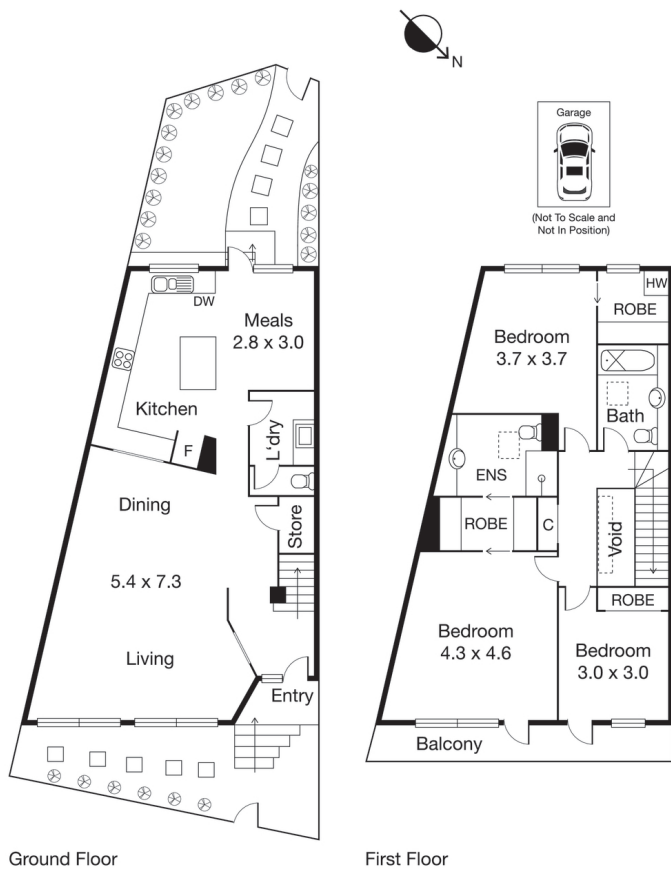

3 2 1

AUCTION Saturday 2 July at 11am

Inspection As advertised or by appointment

Contact Simon Carruthers 0438 811 601
Sean Rice 0432 551 854
Geoff Cayzer 03 9690 9782

Mel Ref 57 H2

CAYZER

Albert Park 330 Montague Street 03 9699 5999
Port Melbourne 370 Bay Street 03 9646 0812

cayzer.com.au

Every care has been taken to ensure the information contained in this document is accurate. The diagrams/plans are a representation only and are not to scale. Interested parties should seek independent legal advice. Cayzer Real Estate Pty Ltd does not accept any responsibility or liability as a result of the information provided in this document. If your property is currently listed for sale with another agent, please disregard this notice. | Cayzer Real Estate Pty Ltd |